



## INSTALLATION FAIRING BRACKET 56

1. Install the fairing according to the drawing below.
2. Install the window with item 7
3. To prepare the ATV loosen (do not remove) the front plastic guard.
4. With a ratchet, extension, universal joint, a ½ socket and a ½ key, loose the 2 screws at the base of the steering. The handlebars must be loose to be able to fix the item 2. Re-tighten the screws with item 2 in place.
5. Re-tighten the front plastic guard.
6. Fix the item 1 as near as possible the to handle bars with the item 3 and 5, without tightening.  
Note: In some cases you may have to move the cullet of the hand-brake lever.
7. Install the fairing with the item 4, 5, and 6 without tightening.
8. Adjust the position of the assembly.
9. Make sure to tighten the bolts sufficiently to avoid loosening caused by vibration.

Caution: Ensure you gave enough room to the gear shift levers and other accessories installed close to the handlebar of the vehicle.

**IMPORTANT: Ensure you to leave enough space necessary for the correct operation of the handbrake lever.**

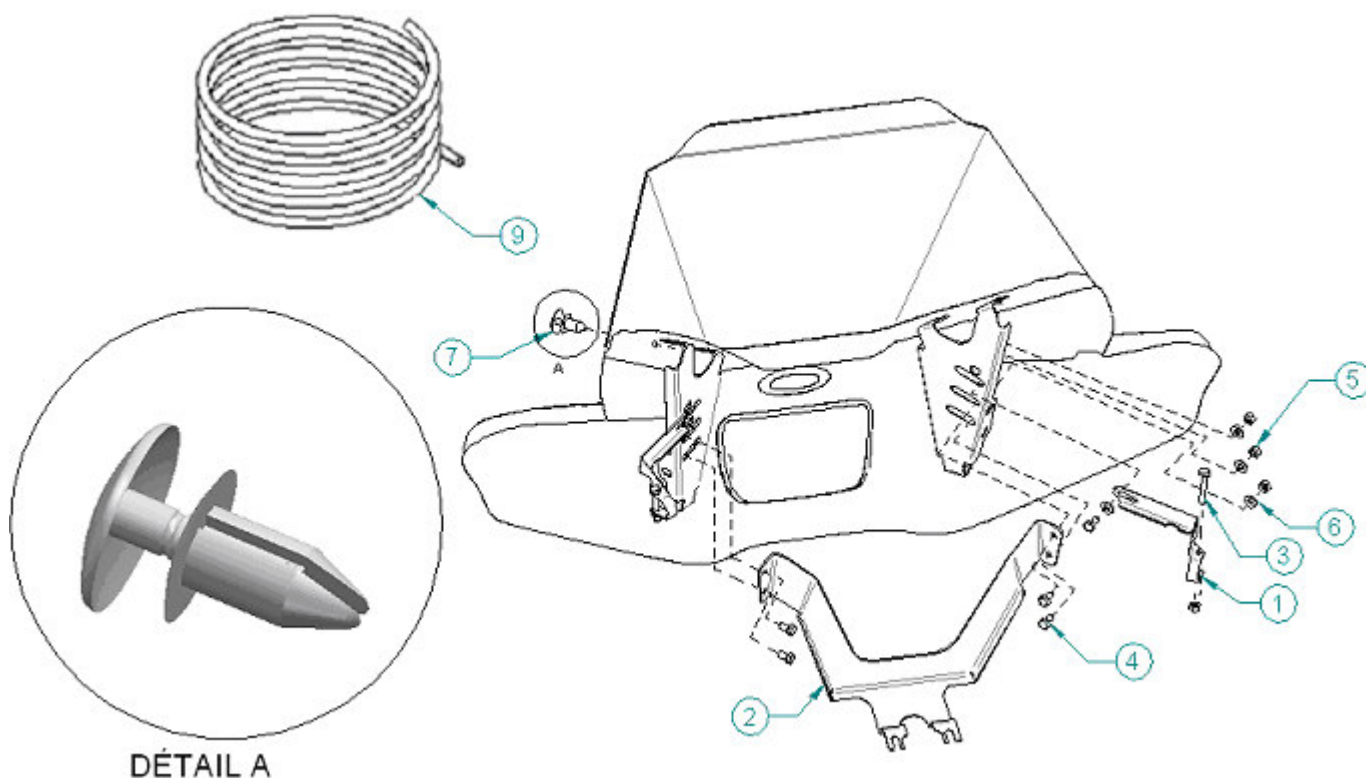

Ref.	Description	Item # (OEM)	Qty.
1	Support of handle right and left	04WB-003D et 04WB-003G	2
2	Angles of fairing	04WA-006	1
3	Hexagonal Bolt 1/4"-20 NC x 1-1/2"	HB-1/4-20NCx1-1/2	2
4	Hexagonal Bolt 1/4"-20 NC x 1/2"	HB-1/4-20NCx1/2	6
5	Hexagonal locknut with nylon 1/4"-20NC	HLN-1/4-20NC	8
6	Flat washer 1/4" SAE white zinc	FW-1/4-SAE	8
7	Pushbutton to retain window	Bouton17.5MM	8
9	2600 mm of trim 8mm ( also available )	TRIM8MM-coupe 2600	0